



How It Works – Steps to use the share cycle -

To get started with share cycle, "COGICOGI Smart!", you need to download the smart phone application to use and return the bike. Please follow the steps below:

1 Download "COGICOGI Smart!" Application

Search by "cogicogi" in Google Play (Android) or in App Store (iOS) and download the application with application icon.



2 Membership Registration

Open your "COGICOGI SMART!" app and create your account.

Tap "Rent & Register" button and register your profile and billing information. You need your credit card and need to approve to the user agreement.

* Note: Please also confirm precaution for the rental fee in website(cogicogi.jp).

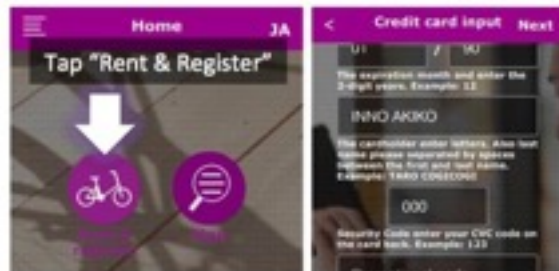

3 Search And Unlock A Bike

After the Registration, navigate to the "Home" page and tap "Rent" button. Please note that you are near the cycle port (cycle station) when you tap this button.

When you are near the cycle port and the app correctly recognize it, the app automatically shows one available bike. Find the bike with the number shown on the app and then tap the number on the app. The light on the back side of the bike start pulsing and you can unlock. Please note that you only have 5 sec to unlock the bike from the light start to pulse.

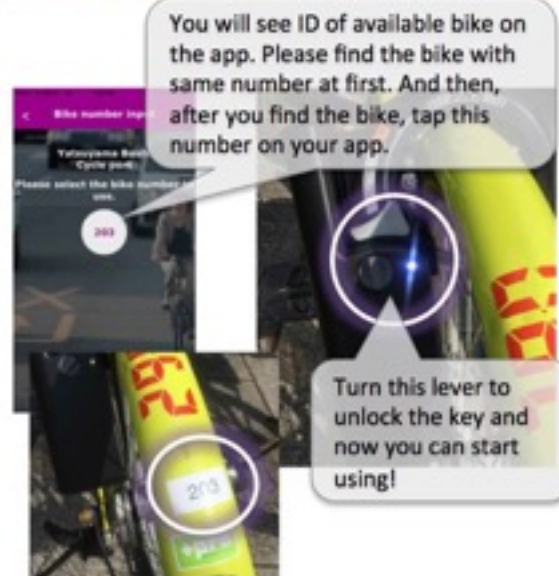

You will see ID of available bike on the app. Please find the bike with same number at first. And then, after you find the bike, tap this number on your app.

Turn this lever to unlock the key and now you can start using!

Returning To The Port

Find the near cycle port from cycle ports. Park the bike you used and lock manually.

And then, tap "RETURN" button on your app.

Once the bike correctly recognized return to the port, you will be finished with returning!

A Brief Stop During A Trip

When you want to park your bike during your trip for a while, you need to lock manually.

When you start using the bike again, now you need your application.

Open your "COGICOGI Smart!" and tap "UNLOCK". Please unlock the bike manually by following same steps when you rent it.

*Note: If you locked (not returned) your bike close to the port, you cannot process "UNLOCK". Please tap "RETURN" and rent another bike.

Manually press the orange button and pull down the lever to lock

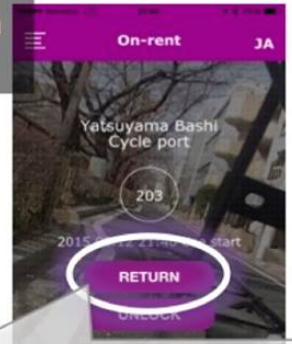

Go to the cycle port at first, manually lock your bike, and then tap this button on your app finally.



The light turns from green to white (white blue), and you will finish returning.



Unlock the bike by tapping this button when you come closer to the bike you locked temporary.



If you have any question, please send us!
E-mail: support@cogicogi.jp